

THE BAKER BUILDING

@ SUMNER CORPORATE PARK



FOR LEASE

60,000 - 379,760 Sq. Ft.

Sumner, Washington



PACIFIC
REAL ESTATE PARTNERS, INC

225 108TH AVENUE NE, SUITE 550
BELLEVUE, WA 98004

For further information please contact:

LESLIE R. BOUDWIN
Vice President
425-974-4023
les@pacific-re.com

W. SCOTT CARTER
Principal
425-974-4004
scott@pacific-re.com

THE BAKER BUILDING

@ SUMNER CORPORATE PARK



BUILDING

- 379,760 square feet, total
- State-of-the-art distribution center
- Divisible to 60,000 square feet
- Office Build to Suit
- 30' clear
- R-11 rigid insulation in the roof
- Rebar upgrades in slab
- Ample power available
- 480 volt/3-phase
- 89 Dock high doors, 8 drive-in doors
- Truck door canopies
- Potential yard for trailer parking
- Expansion possible within Sumner Corporate Park

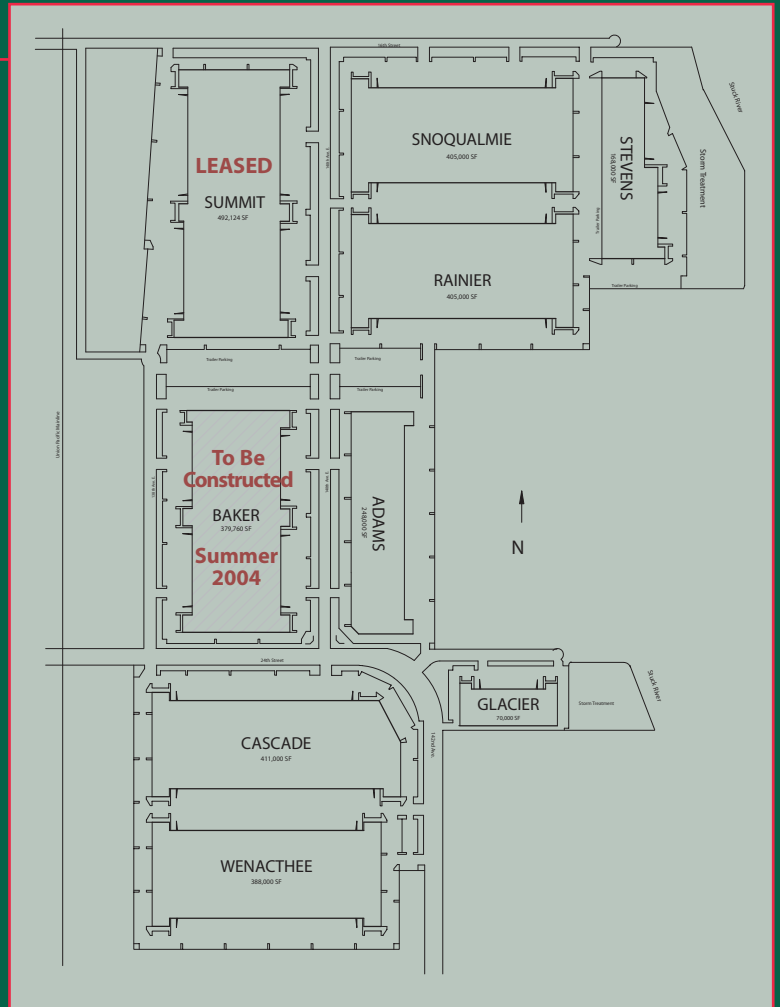

OWNERSHIP

- A Joint Venture of Knapp Development, Michelson Commercial Realty and Washington Capital Management, Inc.

LEASING AGENTS

LESLIE R. BOUDWIN
Vice President
425-974-4023
les@pacific-re.com

W. SCOTT CARTER
Principal
425-974-4004
scott@pacific-re.com

PACIFIC
REAL ESTATE PARTNERS, INC

